

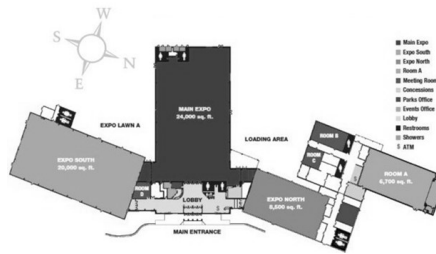

Team Sheen Is Back Again In Michigan ***2023 National All Satin Show*** ***Kalamazoo, Michigan*** ***April 21st-23rd***

Please join the Michigan Satin and Mini Satin Breeders Association as we bring the National All Satin Show back to the Great Lakes State!

2023 NASS will be located at the Kalamazoo County Expo Center. Our 24,000 square foot showroom will easily accommodate all of the Open & Youth Coops, Judging Tables, a Raffle Table, several Vendors, a Cage Dealer, the Youth Contests, a Photo Booth, as well as tables/chairs for Hospitality, Socializing and much more.



The Expo Center is just minutes from downtown Kalamazoo which offers many restaurants, numerous hotels in all major chain groups, fun family attractions and is within an hour of the beautiful coastline of Lake Michigan (while April might be a tad cold for a swim, you cannot argue with the beautiful views our amazing Mitten provides year-round.) Fun Fact: Kalamazoo is also known as Michigan's Craft Beer Capital and at present is home to over 20 Breweries, 3 Distilleries and not to be left out, 5 Wineries!



Camping is available for \$25.00 per night plus a \$5.00 reservation fee by calling the Kalamazoo Expo Center after January 1st. Camping fees are subject to increase and campers will be charged the 2023 rate. Campsites have water and electric hook-ups; a dump station is available on-site. There are also shower and restroom facilities located at the back of Main Expo (our showroom) that are accessible from the Expo Lawn B Campground.



HAPPY

 CAMPERS

Our Host Hotels are conveniently located only 1.9 miles from the Kalamazoo Expo Center and share a parking lot.

The Holiday Inn Express & Suites Kalamazoo offers, free parking, free hot & cold breakfast bar, free high-speed internet in all rooms, on-site business center, heated indoor pool, complimentary fitness center. The rooms feature a mini refrigerator, microwave and coffee maker along with bedside outlets, a plush duvet and your pick of pillow!

National All Satin Show Room Block: 1 King Bed or 2 Queen Beds \$99.00/night

The Four Points by Sheraton Kalamazoo offers free parking, an on-site restaurant and bar, complimentary high-speed internet, on-site business center and fitness center. The rooms feature a mini refrigerator and coffee maker.

National All Satin Show Room Block: 1 King Bed or 2 Queen Beds \$110.00/night with a voucher for 2 Adult Breakfast



Kalamazoo|Battle Creek International Airport (AZO):

American,, Delta

4.7 miles from the Kalamazoo Expo Center, 3.2 miles from the Host Hotels

Car Rental- Avis, Budget, Enterprise, Hertz



Airports that service Alaska Airlines:

Detroit Metropolitan Airport Wayne County (DTW)	120 miles
Chicago- O'Hare International Airport (ORD)	173 miles
Indianapolis International Airport (IND)	240 miles

SHOW OFFICIALS & COMMITTEE CHAIRS 	
General Show Chairman	Tim Kingsbury
Open Satin Superintendent	Chris Garrett
Open Mini Satin Superintendent	Sue Moessner
Youth Mini Satin Superintendent	Cory Lamond
Youth Satin Superintendent	David Kilander
General Show Secretary	Holly Mercer
Assistant Show Secretaries	Alexis Lamond, Debbie Mercer
Auction Chairman	Tim Kingsbury
Banquet Chairman	Nedra Kingsbury
Awards Chairman	Rachel Weber
Raffle Chairman	Megan Kilander, Sherry Callen
Friday Night Hospitality Chairman	Nedra Kingsbury
Cooping & Table Transport Chairman	Ed Mercer
Show Catalog Chairman	Holly Mercer
Merchandise Chairman	Val Counterman, Alexis Lamond

For more information:

General Show Chairman: Tim Kingsbury,
t_nfarms@yahoo.com, (517)-569-2903

General Show Secretary: Holly Mercer,
MichiganTeamSheen@gmail.com,
(517)-204-0234

Follow us on our Facebook page: Michigan Satin & Mini Satin Breeders Association